

Better Homes and Gardens Special Interest Publications.

RENOVATION STYLE

Win
a \$25,000 Bath
Makeover
See flip side, P. 20

*Special
Kitchen
& Bath
Issue*

Flip
FOR KITCHENS

Add Style & Function
Design Experts Show You How

137 Products to Complete Your Look

BEST
BATHS

Seattle,
Washington

Storage
Natural Light
Openness

Light-Filled Splendor

Space-savvy homeowners transform an unneeded bedroom into an expansive master bath.

BY MERVYN KAUFMAN PHOTOGRAPHY BY JOHN GRANEN PRODUCED BY LINDA HUMPHREY



Below Polished chrome bath fittings include an ultracontemporary handheld spray and a unilever temperature control. **Right** In the hall between the master bedroom and bath, a pair of storage cabinets flanks the doorway leading to a large walk-in closet. An upholstered bench with Lucite legs opposite the opening is convenient for pulling shoes on or off. **Opposite** The wall behind the tub hides the shower and a toilet compartment. The greenish tint results from the iron content in the satin-etched glass.



W

When the new owners decided to renovate this early-20th-century three-story home in Seattle, they had specific goals: more yard space for their two youngsters to play, more interior space for the growing family to luxuriate, and enough storage to contain their current and future needs. As the design evolved in a collaboration between their interior designer, Nancy Burfiend, and Stuart Silk Architects. Making room for an expanded master suite also became a top priority. "The new bedroom is smaller than the original, but added to it is a huge walk-in closet with its own storage island," project manager Michael Troyer says. "And at 13x17 feet, the new master bath is about three times the size of the old one. We absorbed one entire second-floor bedroom to create this space."



Voice of Experience

Mirrors can be the answer to maximizing natural light without moving or adding windows. In creating this sunny room, the architects and interior designer arranged the elements to utilize two windows on one wall and a third on an

adjacent wall. A floor-to-ceiling mirror leaning on the wall opposite the window pair adds an illusion of expanded space while bouncing light across the room. A mirror hangs in front of the third window, ideal for applying makeup in natural light.

The owners have differing tastes, so the bath has both traditional and contemporary details. For example, the Murano glass chandelier, similar to what hangs in their renovated kitchen (see "Striking a Balance", flip side of this issue, page 66), is a nod to traditional style, while the freestanding bathtub—a traditional concept—has a contemporary shape.

One of the owners came from a home with little storage, so this new bath is designed with storage that exceeds their current needs to provide a cushion for the future. Another request the architects honored was designing spaces that both homeowners could use at once. Measuring 4x8 feet, the shower, with its heated bench, can accommodate two bathers at one time.

The double vanities, with their raised vessel sinks, give each spouse plenty of elbowroom—and storage. The cabinets

Above Left Beyond the tub and adjacent to the shower door is a custom floor-to-ceiling cabinet designed mainly for towel storage and display, but it's spacious enough to hold other items, including gifts hidden away from children. **Above** Just inside the shower door is a heated marble seat that's out of range of shower sprays. The homeowners say they often put towels on the seat so they're warm when the shower is through. **Opposite** Shelves for brushes, soaps, and shampoos are cut into one wall of the ceramic tile-lined shower stall, which is outfitted with an overhead rain-style showerhead, body sprays, and a handheld shower.



Style Moment
Earth-tone tiles soften the hard expanse of glass and the contemporary chrome fixtures.



The Plans, Before & After

Once a spare bedroom, the sumptuous new master bathroom adjoins the master bedroom and walk-in closet in the architect's floor plan. Because plumbing lines didn't exist in the previous space, installing them was a major part of the redo. The closet space was created by absorbing a few hall closets and a large chunk of an already roomy master bedroom.

BEFORE

The two-story home had an abundance of bedrooms. The homeowners decided it was worth giving up a guest room for a bath they would use every day.

The large master bedroom lacked a walk-in closet, and its elongated shape made furniture placement awkward.

The master bedroom's previous bath (not seen below) was renovated and now serves another bedroom.

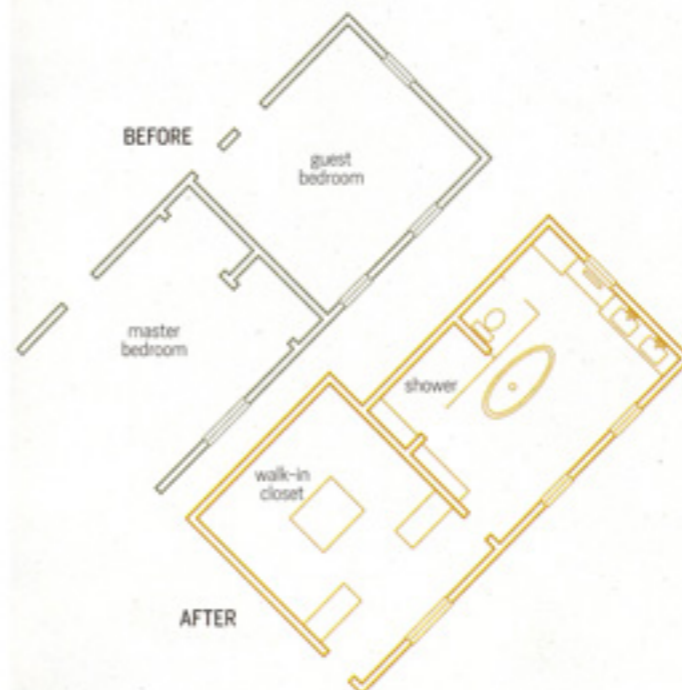

Bench restorationhardware.com



Hand-hammered exposed brads underscore the classic form of this X-base upholstered bench, its design traceable back to ancient Greek and Roman art.

Toscane Linen Nailhead Bench, in sand-tone Belgian linen, Restoration Hardware, \$295

Showerhead hansgrohe.com



This design infuses soothing bubbles in the 2½ gallons-per-minute of water that flows from 107 clog-free overhead channels. Lime and debris buildup are deflected by a quick-clean function.

Raindance 180 AIR Showerhead, in chrome, Hansgrohe, \$616

WE ABSORBED ONE ENTIRE SECOND-FLOOR BEDROOM TO CREATE THIS SPACE.

PROJECT MANAGER MICHAEL TROYER

are custom-crafted of poplar and finished with multiple coats of white water-base paint.

The homeowners say when they purchased the house, they intended to renovate only the master bath and kitchen. After discussions with architects, plans quickly changed and the owners were set on renovating 80 percent of the 1913 Georgian Revival home.

While the project was more extensive and expensive than originally planned, they found efficiencies in doing everything at once—leaving the homeowners with no regrets.

RESOURCES PAGE 33

Above Left The design team's determination to keep countertops uncluttered inspired the double vanities. The wide top drawers tilt out to hold toothbrushes and floss; the closed cabinets conceal other bath supplies. **Above** Each porcelain vessel sink has a contemporary-style single-lever faucet with a built-in spray tip.

AFTER

A walk-in closet now connects the master bedroom and bath, creating an efficient transition for the homeowners.

Discrete zones for each of the bathroom's functional areas help make the room comfortable for dual users.

Because it was once a bedroom, it has three windows, which bring in abundant natural light.

ARCHITECTURE STUART SILK ARCHITECTS
INTERIOR DESIGN NANCY BURFIEND

RESOURCES

Tub Napoli—Victoria + Albert Bath, LLC, Columbia, South Carolina; 803/748-1228, englishbaths.com. **Tub and shower faucets** Axor—Hansgrohe; 800/334-0455, hansgrohe-usa.com. **Chandelier** Murano glass—Design Within Reach; 800/944-2233, dwr.com. **Tile** for flooring and shower from the Studio series in beige by Atlas—Pental Granite & Marble, Seattle; 206/768-1278; pentalonline.com. **Mirror at vanity** Infinity—Room & Board; 800/486-6554; roomandboard.com. **Sinks** Fogo—Duravit USA; 888/387-2848, duravit.com. **Sink faucets**—Dornbracht USA, Inc.; 800/774-1181, dornbracht.com.

MORE RESOURCES PAGE 44