

Better Homes and Gardens Special Interest Publications.

RENOVATION STYLE

Win
a \$25,000 Bath
Makeover
See flip side, P. 20

*Special
Kitchen
& Bath
Issue*

Flip

FOR KITCHENS

Add Style & Function
Design Experts Show You How

137 Products to Complete Your Look

BEST
BATHS

Seattle,
Washington

Storage
Elbowroom
Comfort

Lakeside Luxe

An updated 1955 midcentury modern gets an amenity-filled master bath with a fabulous view.

BY MERVYN KAUFMAN PHOTOGRAPHY BY ALEX HAYDEN PRODUCED BY LINDA HUMPHREY



This photo A wall-mount towel warmer is positioned at the far end of the shower, well away from the four showerheads' water spray. *Opposite* The bathroom's raised gas fireplace sends soothing warmth to the bath as well as the adjacent master bedroom. Built-in storage tidily stows must-haves.



T

Tina and Karl Neiders liked the feel of their midcentury modern home in Seattle. "Mostly we loved the location—right on Lake Washington with a view toward the Cascades," Tina says. But she and Karl wanted to make the house their own by adding to it for their growing family—the Neiderses had two young daughters and a third was born recently. The house's original master suite was small and cramped; plus, the couple wanted their own private spaces—bedroom and bath—to be generous and comfortable.

"We wanted a new bath that was functional as well as beautiful," Tina says. Seattle architect Stuart Silk's solution was to build up, not out, creating a new master bath in an upper-level addition. Working with Silk and interior designer Nancy Burfiend, the Neiderses created a 15×17-foot bathroom that

Voice of Experience

The ideal master bath is not only rich in spa-like amenities, such as heated flooring and well-placed lighting, but it's also arranged so two people can comfortably use it at the same time. Of equal importance is storage—enough to meet future and current needs. When

planning, focus on the ability to keep your countertops clear; plan storage for cosmetics and all bathroom essentials in drawers and behind closed cupboard doors. Stashing these items out of sight will keep your bath inviting, elegant, and uncluttered.



Style Moment
The distinctive brown-and-white marble establishes the room's rich color palette.



Top Double vanities are custom-made of riftsawn walnut in a medium stain. Between them, lowered 6 inches, is homeowner Tina Neiders' makeup table. **Above** Natural light pours into the marble-lined shower through a clerestory window. A combination of fixed and handheld sprayers keeps warm water on the shower's users at all times.

responds to all their expressed desires for function, luxury, and light. New windows open it up to views of the lake and, beyond it, the city of Bellevue, Washington, and distant mountains. Inside, there is a freestanding soaking tub, a shower big enough for two, a makeup table, and custom cabinets produced from a constructive collaboration between architect and designer.

A two-way gas fireplace serves both the master bedroom and bath. "You can lie back in the tub and either look out at the lake or gaze at a crackling fire," Tina says. A huge window that rises from the floor admits vast amounts of daylight, all of which is reflected in a trio of to-the-ceiling mirrors designed to fit directly over the vanities and makeup table.

The floor, countertops, and stall shower are all Noir St. Laurent polished marble. "Its rich darkness makes this large space feel cozy," Tina says. The generous 8x6-foot shower boasts four showerheads—two handheld and two fixed. "Our older girls tend to use the shower almost as much as Karl and I do," she says.

Burfiend attributes the success of this design mainly to the collaborative process that evolved during the planning and construction. "We worked with the architects as part of a team," she says. "That Tina and Karl had been our clients before helped us know exactly what they wanted. We knew the kind of look they liked."

RESOURCES PAGE 43

The Plans

This master bath was built as part of an upper-level addition to a single-level home. Designed so two people can use the space together, the Neiderses' bathroom comprises bathing, showering, and grooming zones, and the toilet occupies its own space, separated by a privacy door.

AFTER

A freestanding tub holds court directly in front of large windows with dramatic views of Lake Washington.

A makeup table separates the sinks. Its work surface—built for a seated user—dips 6 inches below the vanity tops.

A gas fireplace is positioned perfectly for viewing from the tub.

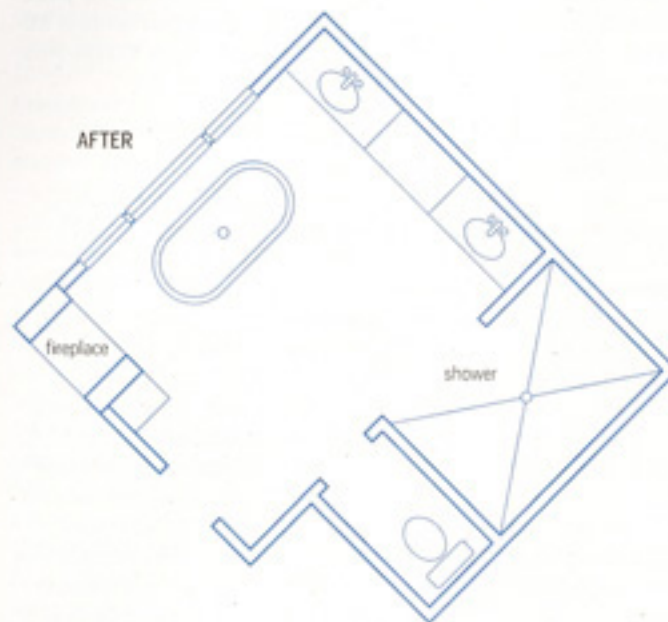

ARCHITECTURE: STUART SILK ARCHITECTS
INTERIOR DESIGN: NANCY BURFIEND

RESOURCES

Marble for wall, floors, and shower Noir St. Laurent marble—Michelangelo Marble, Inc., Seattle; 206/767-6549; michelangelomarble.com. **Towel warmer** Warmatowel #542—Steam & Sauna Connection; 877/728-6280; steamsauna.com. **Tub**—ZUMA Collection; zumacollection.com. **Custom cabinets in riftcut walnut, stained**—contact local lumber retailers. **Cabinet pulls** Tab Pull—Doug Mockett & Co., Inc.; 800/523-1269; mockett.com. **Shower, tub, sink fixtures** Tara—Dornbracht USA, Inc.; 800/774-1181; dornbracht.com. **Sinks**—Kohler Co.; 800/456-4537; us.kohler.com. **Mirrors** custom oil-rubbed bronze—Starcraft; usstarcraft.com. **Scances** Eureka—George Kovaks Lighting, a division of the Minka Group; 800/221-7977; minkagroup.net.

MORE RESOURCES PAGE 44

Create a similar richness
in your own renovated
bathroom with these
products.

Towel Warmer

mrsteam.com



Warm your towels with wall-mount convenience. Turn on the unit and hot water from a closed-loop, all-brass heating system will immediately circulate throughout.

Hydronic Towel Warmer (H542), Mr. Steam, brushed nickel, \$1,200, or polished chrome, \$900

Showerhead

hansgrohe.com



This oversize showerhead boasts 72 clog-free channels that dispense 2½ gallons of water per minute. A trademarked quick-cleaning system resists lime scale and debris buildup.

Clubmaster showerhead (28496), Hansgrohe, starting at \$178